

Reed relay

G1AXX2000



G2AXX0000



Contact Form	SPST-NO							DPST-NO						
Contact Resistance	100 m Ω max. initial							100 m Ω max. initial						
Insulation Resistance	10 ¹¹ Ω min.							10 ¹¹ Ω min.						
Power	10 VA max.							10 VA max.						
Switching Voltage	200 VDC max.							200 VDC max.						
Switching Current	0.5 Amps max.							0.5 Amps max.						
Minimum Breakdown Voltage	1500 VDC between coil & contact							1500 VDC between coil & contact						
Nominal Voltage (VDC)	3	5	6	8	9	12	24	3	5	6	8	9	12	24
Coil Resistance ±10% (V)	63	500	500	700	700	1050	2080	63	500	500	700	700	1050	2080
Must Operate (VDC)	2.1	3.5	4.2	5.6	6.3	8.4	16.8	2.1	3.5	4.2	5.6	6.3	8.4	16.8

Features

- Molded epoxy body
- Sealed construction permits automatic flow soldering and cleaning
- High reliability relays
- Cost effective
- XX is nominal voltage option

- Molded epoxy body
- Sealed construction permits automatic flow soldering and cleaning
- High reliability relays
- Cost effective
- XX is nominal voltage option

Circuit Schematic
Top View

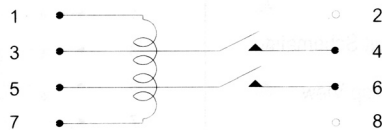
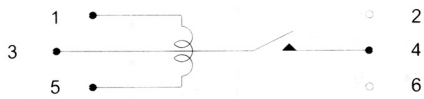

External Dimension
and PCB Layout
Unit: mm

PCB Layout

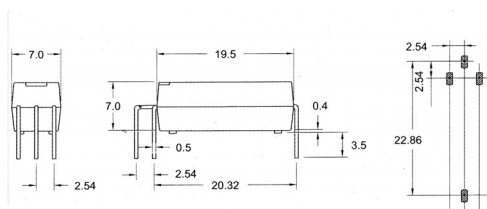

PCB Layout

